

Application

LED bollard luminaires with unshielded 180° light distribution and safety guard designed for use in the illumination of gardens and residential installations. Provided with mounting system that allows the luminaire to be adjusted independent of anchor bolt orientation.

Materials

Luminaire housing, tube and base plate constructed of die-cast and extruded marine grade, copper free ($\leq 0.3\%$ copper content) A360.0 aluminum alloy
 Three-ply opal glass
 High temperature silicone gasket
 Mechanically captive stainless steel fasteners
 Anchorage constructed of galvanized steel

NRTL listed to North American Standards, suitable for wet locations
 Protection class IP 65
 Weight: 6.6 lbs

Electrical

| | |
|---------------------------|-------------------|
| Operating voltage | 120-277V AC |
| Minimum start temperature | -30° C |
| LED module wattage | 3.9W |
| System wattage | 5.6W |
| Controllability | 0-10V dimmable |
| Color rendering index | Ra > 80 |
| Luminaire lumens | 94 lumens (3000K) |
| Lifetime at Ta = 15° C | > 500,000 h (L70) |
| Lifetime at Ta = 40° C | 238,000 h (L70) |

LED color temperature

- 4000K - Product number + **K4**
- 3500K - Product number + **K35**
- 3000K - Product number + **K3**
- 2700K - Product number + **K27**

BEGA can supply you with suitable LED replacement modules for up to 20 years after the purchase of LED luminaires - see website for details

Finish

All BEGA standard finishes are matte, textured polyester powder coat with minimum 3 mil thickness.

| | | | |
|------------------|--------------|--------------|------|
| Available colors | Black (BLK) | White (WHT) | RAL: |
| | Bronze (BRZ) | Silver (SLV) | CUS: |

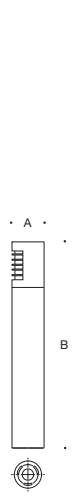

| Bollard · Indirect light | | | | |
|--------------------------|------|--------|---------|--------------|
| | LED | A | B | Anchorage |
| 84024 | 3.9W | 4 3/8" | 28 3/4" | 79824 |



Type:
 BEGA Product:
 Project:
 Modified: