

Tools Required:

- 4mm hex key
- 13mm socket wrench

Protection Class: IP66

Weight: 10.5 lbs.

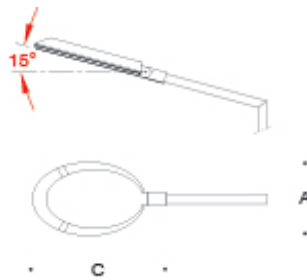

Dimensions

- A:** 10-1/4 "
- B:** 2-1/8 "
- C:** 22 "



Notice to Installer for 77 855:

1. See page 2 for specific product safety warnings.
2. For side mounted pole applications only.
3. Slip fits **minimum** 1-5/8" tenon poles only.
4. LED module and integral driver provided by BEGA.
5. Pole top luminaire supplied with 25 feet of cable to route through pole.
6. Do NOT remove moisture absorption packet from luminaire housing.

77 855 - installation:

1. Lead luminaire wires into pole and through to the base.
2. Secure luminaire head to pole by tightening (x6) 4mm hex screws.
3. To adjust beam direction (up to 15 degrees), undo hex nut and adjust joint. Be sure teeth are secured into position. **BE CAREFUL AS THE FIXTURE WILL DROP QUICKLY UPON LOOSENING.**
4. Make supply wiring and luminaire wiring connections inside pole base:
 MAIN VOLTAGE SUPPLY WIRE TO BLACK LUMINAIRE WIRE
 NEUTRAL (COMMON) SUPPLY WIRE TO WHITE LUMINAIRE WIRE
 GREEN GROUND WIRE TO GREEN LUMINAIRE WIRE

Dimming (if applicable):

- DIMMING CONTROL WIRE (+) TO POSITIVE LUMINAIRE DIM CONTROL WIRE
- DIMMING CONTROL WIRE (-) TO NEGATIVE LUMINAIRE DIM CONTROL WIRE

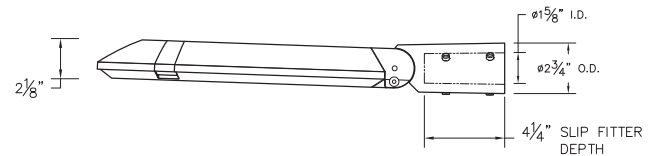
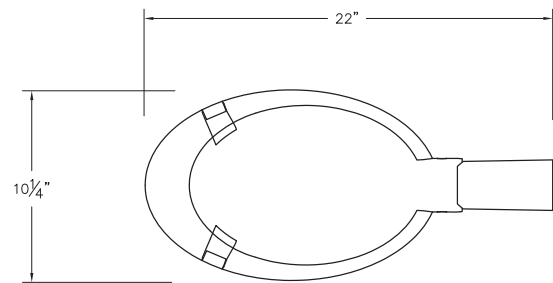

Relamping/Maintenance

No relamping necessary.

Accessories

Please refer to the appropriate accessory installation sheet for further instruction when applicable.

Replacement Parts

Description	Part No
Lens	141021
Housing gasket	831126
LED driver	75985-03
LED module (4000K) (2x)	LED-0414/840

Lamp: 38.0 W LED Module

Product Safety Warnings:

MIN 60°C SUPPLY CONDUCTORS.

THIS PRODUCT MUST BE INSTALLED IN ACCORDANCE WITH THE APPLICABLE INSTALLATION CODE BY A PERSON FAMILIAR WITH THE CONSTRUCTION AND OPERATION OF THE PRODUCT AND THE HAZARDS INVOLVED.

SUITABLE FOR WET LOCATIONS.

LES FILS D'ALIMENTATION 60°C MIN.

CE PRODUIT DOIT ÊTRE INSTALLÉ SELON LE CODE D'INSTALLATION PERTINENT, PAR UNE PERSONNE QUI CONNAÎT BIEN LE PRODUIT ET SON FONCTIONNEMENT AINSI QUE LES RISQUES INHÉRENTS.

CONVIENT AUX EMPLACEMENTS MOUILLÉS.