

**Tools Required:**

For small-scale floodlights

2.5mm hex key (for 5-1/2 ")  
3mm hex key (for 6-1/4 " and 9 ")  
Medium slotted screwdriver

**Louver accessory installation onto floodlights:**

1. Loosen screws on outer luminaire faceplate trim.
2. Disassemble lens, gasket, and reflector.
3. Insert louver into center holes of the reflector. (figure 1)
4. Re-assemble lens, reflector and gasket; Make sure gasket is positioned correctly; (figure 2)
5. Close floodlight trim and tighten screws evenly and fully to secure.

NOTE: Louver may be used with other floodlight accessories.  
Louver prevents glare in lateral direction up to 45°.

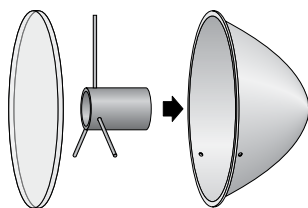
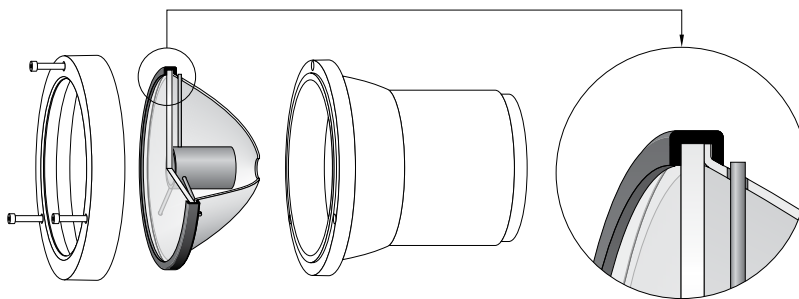
**Figure 1****Figure 2****Accessories**

Please refer to the appropriate  
accessory installation sheet for  
further instruction when applicable.

**Louver:**

5-1/2 " (LED)	70 760
5-1/2 "	70 785
6-1/4 " (LED)	70 796
6-1/4 "	70 797
9 "	70 798