

Tools Required:

For small-scale floodlights

- 2.5mm hex key (for 4-1/8 " and 5-1/2 ")
- 3mm hex key (for 6-1/4 " and 9 ")
- Medium slotted screwdriver

Glare shield accessory installation onto floodlights:

1. Loosen screws on outer luminaire faceplate trim.
2. Remove faceplate trim from floodlight housing.
3. Lead luminaire faceplate trim over glare shield and place back into floodlight housing. (figure 1)
4. Turn shield to desired position and tighten screws evenly and fully to secure. (figure 2)

NOTE: Glare shield may be used with other floodlight accessories. Can be installed by 360° and prevent glare in one direction up to 45°.

Figure 1

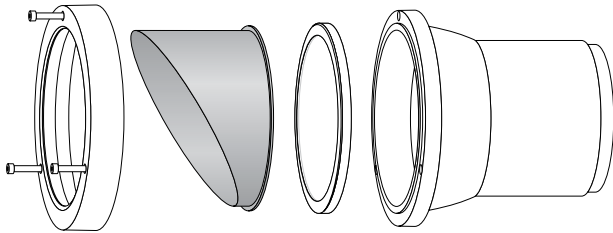
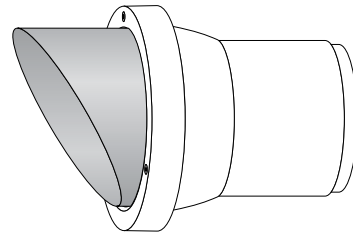

Figure 2



Accessories

Please refer to the appropriate accessory installation sheet for further instruction when applicable.

Glare shield:

Floodlight Diameter	Accessory Number
4-1/8 "	70 755
5-1/2 "	70 756
6-1/4 "	70 757
9 "	70 758

*Dimensions of glare shield listed on website

In the interest of product improvement, BEGA reserves the right to make technical changes without notice.