

Tools Required:

- 3mm Hex Key
- 4mm Hex Key
- Phillips medium screwdriver
- Standard medium screwdriver



Dimensions

- A: 39-3/8"
- B: 6-1/2"

Weight: 43.65 lbs.

Notice to Installer for 24 730:

- For ceiling or wall applications only.
- Mounts directly to finished surface over standard recessed 4" octagonal wiring box (by others).
- In conformance with UL Standard 1598, a silicone based sealant must be used between luminaire and supporting surface.
- LEDs are high-quality electronic components! Please avoid touching the light output opening of the LED directly during installation.
- IMPORTANT: The installation surface must have an adequate load-bearing capacity.

24 730 - Installation:

- Open luminaire by loosening (1) 3mm hex head screws on canopy of fixture. Then, turn the mounting plate counter-clockwise to remove it from the housing.
- Un-hook (4) steel cables from luminaire housing by unscrewing 4mm hex head screw and routing steel cable through catch.
- Route wires to wiring box and make supply and luminaire wiring connections inside wiring box:

MAIN VOLTAGE SUPPLY WIRE TO BLACK LUMINAIRE WIRE
NEUTRAL (COMMON) SUPPLY WIRE TO WHITE LUMINAIRE WIRE
GREEN GROUND WIRE TO GREEN LUMINAIRE WIRE

Dimming (if applicable):

DIMMING CONTROL WIRE (+) TO POSITIVE DRIVER DIM CONTROL WIRE
DIMMING CONTROL WIRE (-) TO NEGATIVE DRIVER DIM CONTROL WIRE

- Install mounting plate onto finished surface using appropriate hardware (by others).
- Place a small bead of silicone around the back side of the luminaire base that will come in contact with the finished wall (exterior applications only).
- Re-connect (4) steel cables by routing each through catch and tightening the 4mm hex head screw to lock into place.
- To close luminaire cover, fit diffuser and frame over mounting plate and tighten (1) 3mm hex head screws to secure. Ensure the gasket is seated properly.

Figure 1: Open / Close Fixture

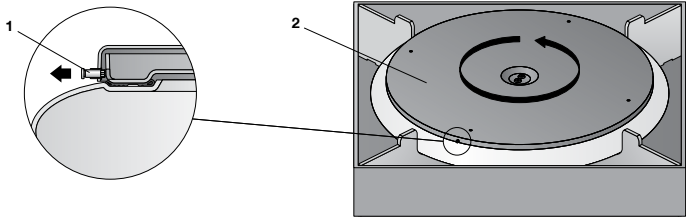
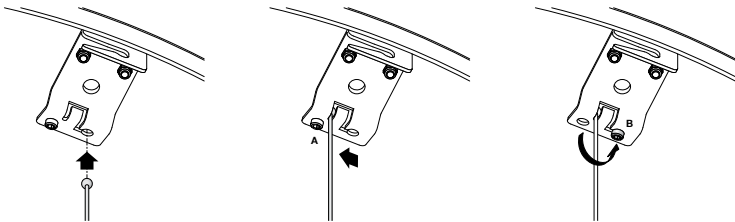

Figure 2: Steel Cable Detail



Relamping/Maintenance

Clean luminaire and lens using only solvent-free cleansers. No relamping required.

Accessories

Please refer to the appropriate accessory installation sheet for further instruction when applicable.

Replacement Parts

Description	Part No
Driver (120-277V)	76085-1050
LED Module (3000K)	(x4) LED-0704/930
LED Module (4000K)	(x4) LED-0704/940

Lamp: 92.4W LED

In the interest of product improvement, BEGA reserves the right to make technical changes without notice.

Product Safety Warnings:

THIS PRODUCT MUST BE INSTALLED IN ACCORDANCE WITH THE APPLICABLE INSTALLATION CODE BY A PERSON FAMILIAR WITH THE CONSTRUCTION AND OPERATION OF THE PRODUCT AND THE HAZARDS INVOLVED. SUITABLE FOR WET LOCATIONS.

MIN 90°C SUPPLY CONDUCTORS.

CE PRODUIT DOIT ÊTRE INSTALLÉ SELON LE CODE D'INSTALLATION PERTINENT, PAR UNE PERSONNE QUI CONNAÎT BIEN LE PRODUIT ET SON FONCTIONNEMENT AINSI QUE LES RISQUES INHÉRENTS. CONVIENT AUX EMPLACEMENTS MOUILLÉS.

LES FILS D'ALIMENTATION 90°C MIN.
