

**Tools Required:**

- 5mm hex key
- Phillips head medium screwdriver

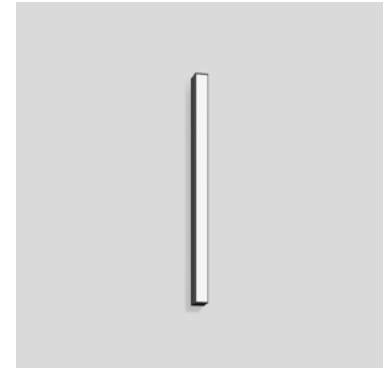
**Protection Class:** IP65

**Weight:** 11.9 lbs.



**Dimensions**

- A:** 40"
- B:** 2-3/8"
- C:** 3-3/4"



**Notice to Installer for 24 319:**

- BEGA luminaires may be damaged if connected to conduit systems containing water- Article 300-5G of National Electric Code requires that "Conduits or raceways through which moisture may contact energized live parts shall be sealed or plugged at either or both ends".**
- For attachment to wall over separate small opening linear wiring box (19 537 provided by BEGA).
- Wiring box needs to be recessed into wall and must be flush with the finished surface.
- In conformance with U.L. Standards 1598, a silicone-based sealant **MUST** be used between the mounting plate edge and supporting wall.
- LEDs are high-quality electronic components! Please avoid touching the light output opening of the LED directly during installation.

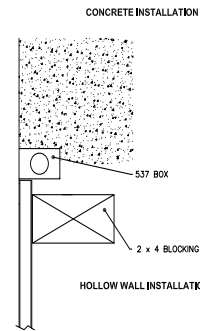
**19 537 - wiring box installation:**

**Hollow (stud) wall construction** - Secure wiring box to wood or metal horizontal blocking as shown in Fig 1. Connect conduit to wiring box (if needed) and pull wires for electrical connections to be made later.

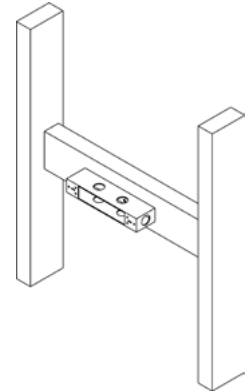
**Poured concrete construction** - Attach wiring box to the concrete form. Connect conduit to wiring box (if needed) and pull wires for electrical connections to be made later. Pour concrete and remove form.

**IMPORTANT: Do not pour concrete directly on to box!**

**Fig 1**

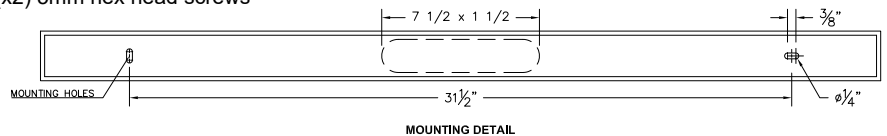


**Fig 2: Generic Image**



**24 319 - Installation:**

- Loosen (x2) 5mm hex head screws on side of fixture to remove luminaire base.
- Route wires through luminaire base into junction box.
- Make supply wiring and luminaire wiring connections inside the single gang wiring box:  
 MAIN VOLTAGE SUPPLY WIRE TO BLACK LUMINAIRE WIRE  
 NEUTRAL (COMMON) SUPPLY WIRE TO WHITE LUMINAIRE WIRE  
 GREEN GROUND WIRE TO GREEN LUMINAIRE WIRE  
 0-10V DIMMING (if applicable):  
 DIMMING CONTROL WIRE (+) TO POSITIVE LUMINAIRE DIM CONTROL WIRE  
 DIMMING CONTROL WIRE (-) TO NEGATIVE LUMINAIRE DIM CONTROL WIRE
- Mount luminaire base directly to finished ceiling using appropriate mounting hardware (by others). Minimum size: 8-32 screws. See mounting detail below.
- Place a small bead of silicone around the back side of the luminaire base that will come in contact with the finished surface (exterior applications only).
- Re-attach luminaire housing to luminaire baseplate and tighten (x2) 5mm hex head screws to secure. Do not over tighten.



**Relamping/Maintenance**

Clean regularly with solvent-free cleansers.  
Do not use high pressure cleaners.

**Accessories**

Please refer to the appropriate accessory installation sheet for further instruction when applicable.

**Replacement Parts**

Description	Part No
LED Driver	75969-02
LED Module (3000K)	(x4) LED-0772/830
LED Module (4000K)	(x4) LED-0772/840

**Lamp:** 32W LED

In the interest of product improvement, BEGA reserves the right to make technical changes without notice.

**Product Safety Warnings:**

**THIS PRODUCT MUST BE INSTALLED IN ACCORDANCE WITH THE APPLICABLE INSTALLATION CODE BY A PERSON FAMILIAR WITH THE CONSTRUCTION AND OPERATION OF THE PRODUCT AND THE HAZARDS INVOLVED. SUITABLE FOR WET LOCATIONS.**

**MIN 90°C SUPPLY CONDUCTORS.**

**CE PRODUIT DOIT ÊTRE INSTALLÉ SELON LE CODE D'INSTALLATION PERTINENT, PAR UNE PERSONNE QUI CONNAÎT BIEN LE PRODUIT ET SON FONCTIONNEMENT AINSI QUE LES RISQUES INHÉRENTS. CONVIENT AUX EMPLACEMENTS MOUILLÉS.**

**LES FILS D'ALIMENTATION 90°C MIN.**

---