

Tools Required:

- 4mm hex head screwdriver
- 11/32" nut driver
- Phillips head medium screwdriver
- Flat head screwdriver

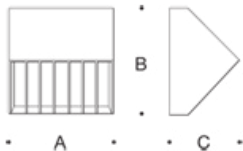

Dimensions

- A: 7-7/8"
- B: 7-7/8"
- C: 5-3/8"



Protection Class: IP65

Weight: 4.4 lbs

Notice to Installer for 24 220:

- For wall applications only.
- Mounts directly to standard recessed 4" wiring box (by others) using mounting kit (provided).
- In conformance with UL Standard 1598, a silicone based sealant must be used between luminaire and supporting wall.
- LEDs are high-quality electronic components! Please avoid touching the light output opening of the LED directly during installation.

24 220 - installation:

- Loosen (4) 4mm hex head screws on front of fixture to remove fixture faceplate from luminaire base.
- Install (2) long 8-32 x 1 1/2" mounting screws (provided) in the back of the adapter plate as shown.
- Attach adapter plate to wiring box using (2) 8-32 x 1/2" screws provided. Feed luminaire wires through luminaire base and adapter plate.
- Make supply wiring and luminaire wiring connections in the octagonal wiring box:
MAIN VOLTAGE SUPPLY WIRE TO BLACK LUMINAIRE WIRE
NEUTRAL (COMMON) SUPPLY WIRE TO WHITE LUMINAIRE WIRE
GREEN GROUND WIRE TO GREEN LUMINAIRE WIRE

- Dimming (if applicable):
DIMMING CONTROL WIRE (+) TO POSITIVE DRIVER DIM CONTROL WIRE
DIMMING CONTROL WIRE (-) TO NEGATIVE DRIVER DIM CONTROL WIRE
- Place a small bead of silicone around the back side of the luminaire base that will come in contact with the finished wall (exterior applications only).
 - Attach luminaire base to adapter plate over the mounting screws using the (2) acorn nuts provided in the mounting kit. Tighten the nuts to back the screws into the wiring box and secure the plate to the box. NOTE orientation labels on luminaire base and position base on mounting surface.
 - Replace fixture faceplate and tighten (4) 4mm hex head screws to secure. Make sure the gasket is seated correctly.

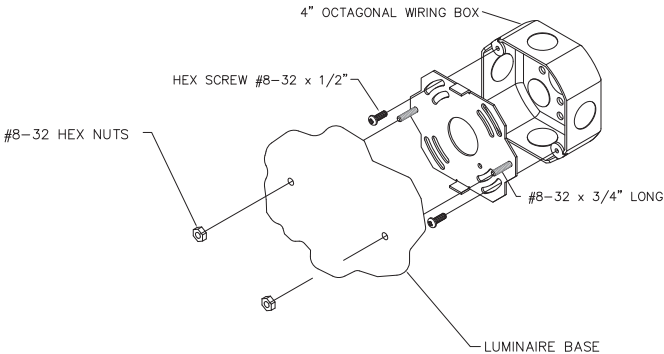

Relamping/Maintenance

Clean luminaire regularly with solvent-free cleansers. Do not use high pressure cleaners.

Accessories

Please refer to the appropriate accessory installation sheet for further instruction when applicable.

Replacement Parts

Description	Part No
Face Plate	FP24220
Driver (120-277V)	75983-01
LED Module (3000K)	LED-0738/830
LED Module (4000K)	LED-0738/840

Lamp: 8.9W LED

In the interest of product improvement, BEGA reserves the right to make technical changes without notice.

Product Safety Warnings:

THIS PRODUCT MUST BE INSTALLED IN ACCORDANCE WITH THE APPLICABLE INSTALLATION CODE BY A PERSON FAMILIAR WITH THE CONSTRUCTION AND OPERATION OF THE PRODUCT AND THE HAZARDS INVOLVED. SUITABLE FOR WET LOCATIONS.

MIN 90°C SUPPLY CONDUCTORS.

CE PRODUIT DOIT ÊTRE INSTALLÉ SELON LE CODE D'INSTALLATION PERTINENT, PAR UNE PERSONNE QUI CONNAÎT BIEN LE PRODUIT ET SON FONCTIONNEMENT AINSI QUE LES RISQUES INHÉRENTS. CONVIENT AUX EMPLACEMENTS MOUILLÉS.

LES FILS D'ALIMENTATION 90°C MIN.
