

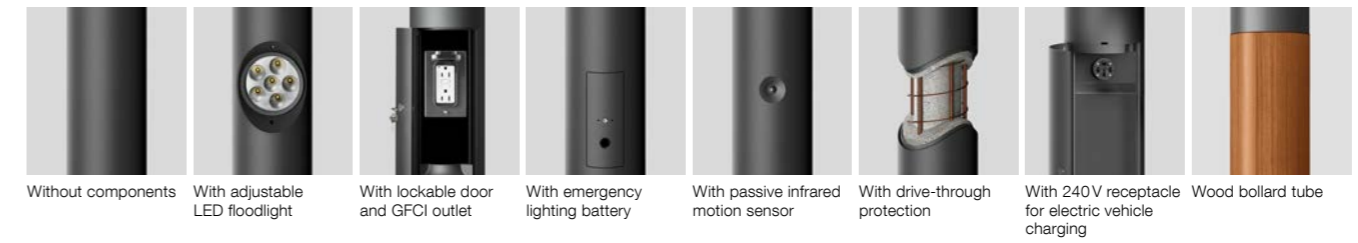

For matching bollard tubes, see Page 244.



Without components With adjustable LED floodlight With lockable door and GFCI outlet With emergency lighting battery With passive infrared motion sensor With drive-through protection With 240V receptacle for electric vehicle charging Wood bollard tube



Closing head w/o illumination function

System bollards
shielded

A series of BEGA system bollard heads with shielded 360° light distribution. Simply order the bollard head and also the required bollard tube in various heights and options. Both modules can be joined together easily and quickly during the installation. Provided with mounting system that allows the luminaire to be adjusted independent of anchor bolt orientation.

Die-cast and extruded aluminum · Clear safety glass

LED color temperatures: 2700K, 3000K, 3500K, 4000K

BEGA luminaires offer a minimum service life of 60,000 hours, with suitable LED replacement modules guaranteed for up to 20 years after date of purchase. Further LED technical data including luminous flux, CRI, dimming and electrical characteristics are provided on the individual luminaire specification sheets, available at www.bega-us.com

All BEGA standard finishes are matte, textured powder coat with minimum 3 mil thickness. BEGA Unidure® finish, a fluoropolymer technology, provides superior fade protection in Black, Bronze, and Silver. BEGA standard White, as well as optionally available RAL and custom colors, are a polyester powder.

NRTL listed to North American standards · Suitable for wet locations
Protection class IP 65



Bollard heads · shielded · 360°			
	LED	A	B
99 862	16.5 W	7 ½	5%
99 865	29.4 W	10%	7 ½

