

DIRECTION OF ILLUMINATION

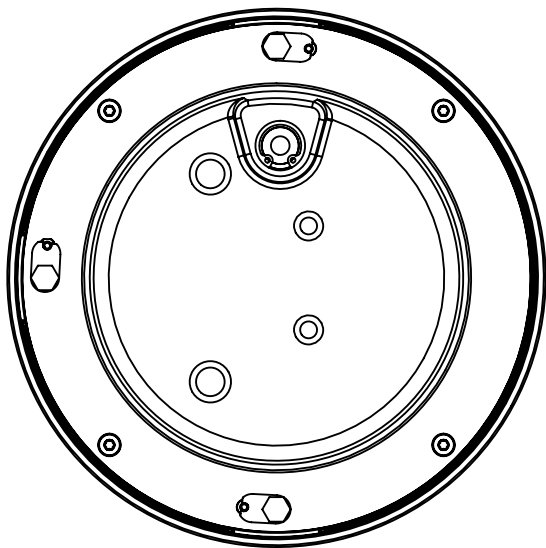

- NOTES:
1. INCLUDED: KIT #40 WATERPROOF CONNECTOR KIT
  2. INCLUDED: BB84618 INSTALLATION HOUSING

REV	CHANGED BY	DESCRIPTION	DATE

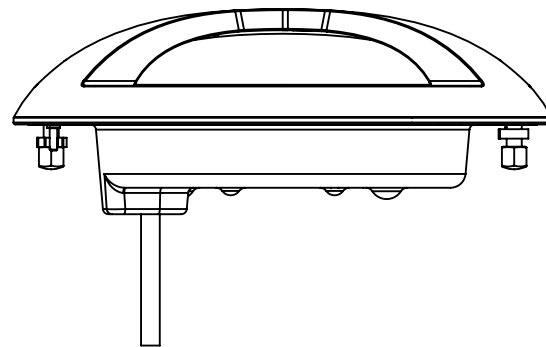
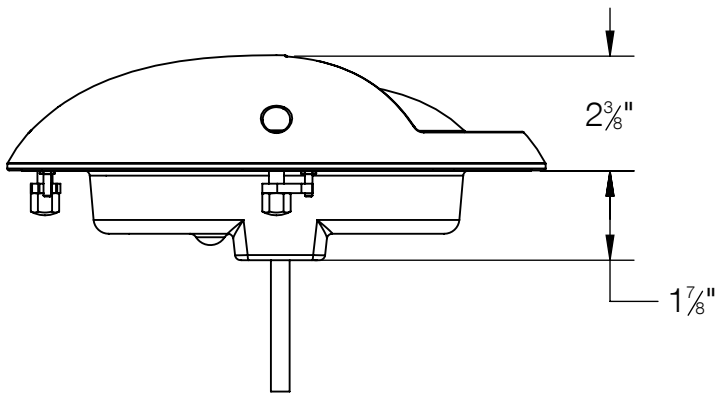
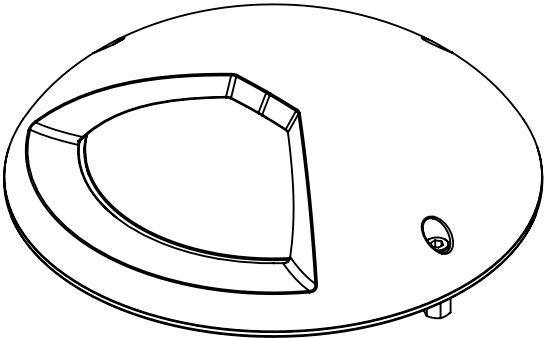

**BEGA**

1000 BEGA Way, Carpinteria, California 93013 P (805) 684-0533 - [www.bega-us.com](http://www.bega-us.com)

APPROVED: \_\_\_\_\_ DATE: \_\_\_\_\_ DESCRIPTION: IN-GRADE FLOODLIGHT - WALL WASHER  
TYPE: \_\_\_\_\_

PROPRIETARY AND CONFIDENTIAL THE INFORMATION CONTAINED IN THIS DRAWING IS THE SOLE PROPERTY OF BEGA NORTH AMERICA, INC. ANY REPRODUCTION IN PART OR AS A WHOLE WITHOUT THE WRITTEN PERMISSION OF BEGA NORTH AMERICA, INC. IS PROHIBITED.	SIZE	PART NO.	REV
	B	84618	-
NOT TO SCALE		10/30/2020	SHEET 1 OF 2

REV	CHANGED BY	DESCRIPTION	DATE

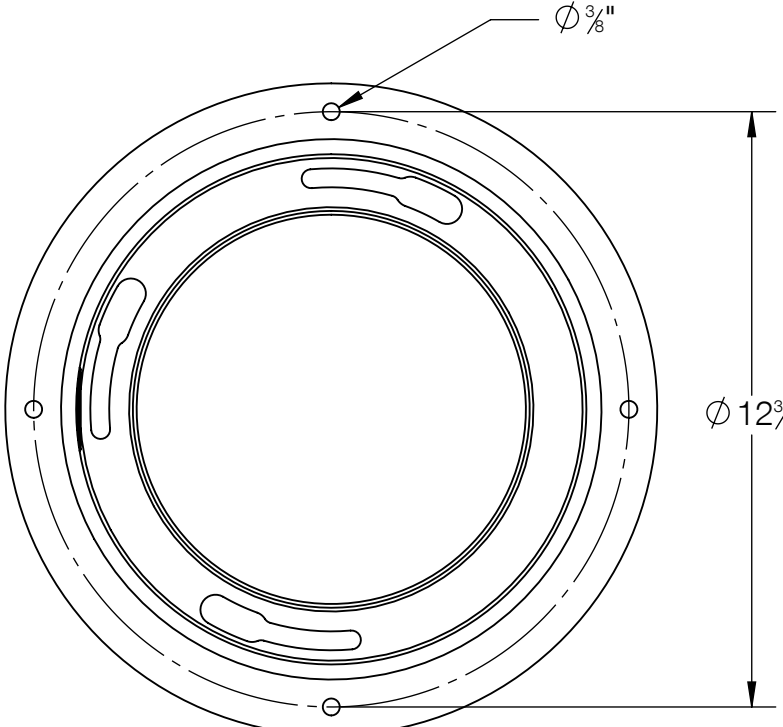
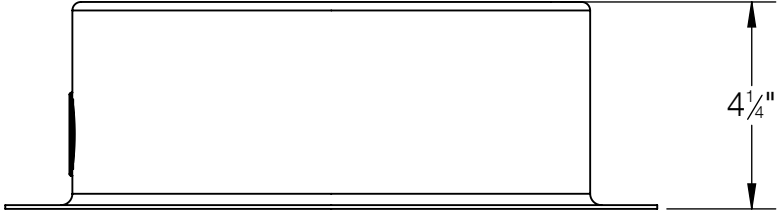
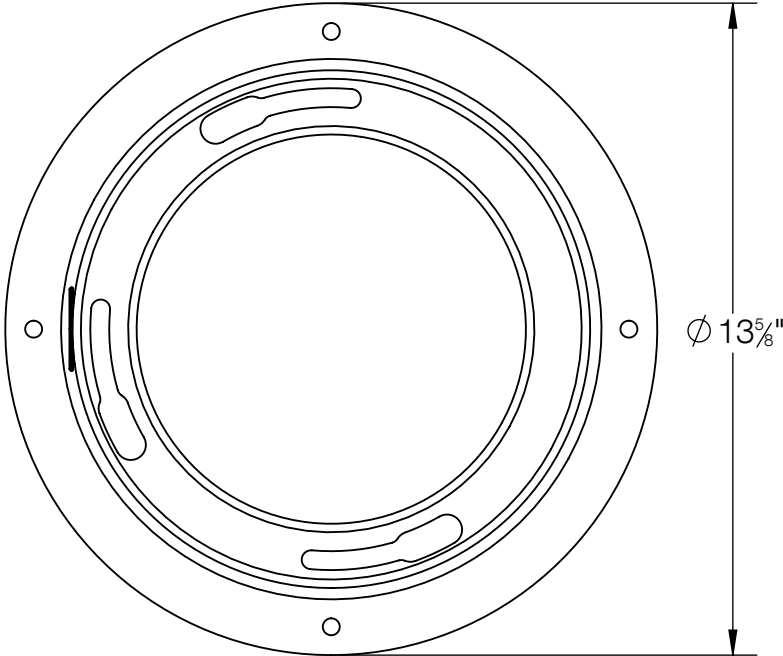

DIRECTION OF ILLUMINATION  
→

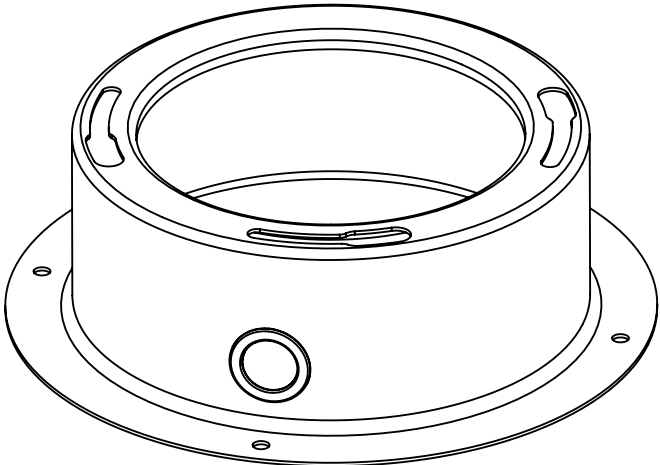
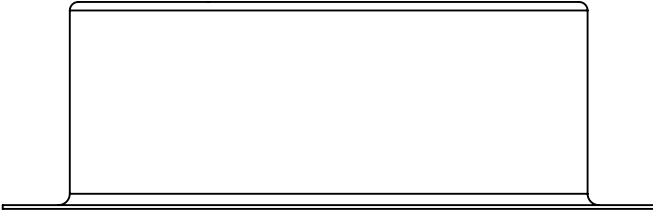

- NOTES:
1. INCLUDED: KIT #40 WATERPROOF CONNECTOR KIT
  2. INCLUDED: BB84618 INSTALLATION HOUSING

BEGA				
1000 BEGA Way, Carpinteria, California 93013			P (805) 684-0533 - www.bega-us.com	
APPROVED: _____		DATE: _____		DESCRIPTION: INSTALLATION HOUSING
TYPE: _____				
PROPRIETARY AND CONFIDENTIAL THE INFORMATION CONTAINED IN THIS DRAWING IS THE SOLE PROPERTY OF BEGA NORTH AMERICA, INC. ANY REPRODUCTION IN PART OR AS A WHOLE WITHOUT THE WRITTEN PERMISSION OF BEGA NORTH AMERICA, INC. IS PROHIBITED.		SIZE	PART NO.	REV
		B	BB84618	-
		NOT TO SCALE	10/30/2020	SHEET 2 OF 2